

C:\Autocad\AcPublish\_24152.01 EFP.dwg || Tabname :01 EFP || May 11, 2020 - 10:58am || twallace

Written dimensions shall have priority over scaled dimensions. All dimensions, elevations, locations, and conditions, shall be verified by the Contractor prior to construction, and the Owner and Boucher & James, Inc. shall be notified of any discrepancies with the information shown on drawings. Only those plans incorporating the raised or red ink professional seal shall be considered official and relied upon. All ideas, designs and arrangements presented hereon were developed for use on, and in connection with, the specified project being prepared for the Owner. These plans may not be reproduced or altered without the expressed written permission of Boucher & James, Inc. Information shown on this plan represents professional services expressing ideas and designs developed, owned and copyrighted by Boucher & James, Inc. Reproduction of this plan without written approval of Boucher & James, Inc. is not permitted. Unauthorized reproduction of a copy of this plan for any purpose will be considered a violation of the copyright laws and a theft of corporate assets. Unauthorized alterations of the plan will be considered a violation of the professional code of ethics. Any violation will be prosecuted to the fullest extent of current statutes.

REVISIONS :			
DATE	DESCRIPTION	DATE	DESCRIPTION

PROJECT :	CHIARAMONTE PARK ADA IMPROVEMENTS SPRINGFIELD TOWNSHIP MONTGOMERY COUNTY, PENNSYLVANIA
APPLICANT :	SPRINGFIELD TOWNSHIP 1510 PAPER MILL ROAD WYNDMORR, PA 19038

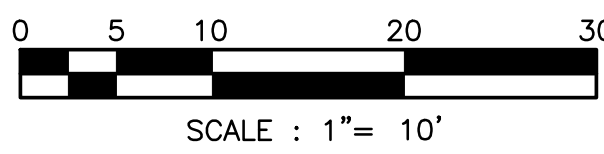

JOB NO.:	1940161	TITLE :	EXISTING FEATURES/ DEMOLITION PLAN
DRAWN BY:	TMW	<b>Boucher &amp; James, Inc.</b> CONSULTING ENGINEERS DOYLESTOWN • BETHLEHEM • STROUDSBURG CORPORATE HEADQUARTERS: 1456 FERRY RD, BUILDING 500, DOYLESTOWN, PA. 18901 VOICE: (215) 345-9400 FAX: (215) 345-9401 www.bjengineers.com	
CHECKED BY:	MWE		
SCALE:	1" = 10'	PROJECT NAME :	CHIARAMONTE PARK ADA IMPROVEMENTS
PLAN STATUS:	FINAL	DATE:	MAY 8, 2020

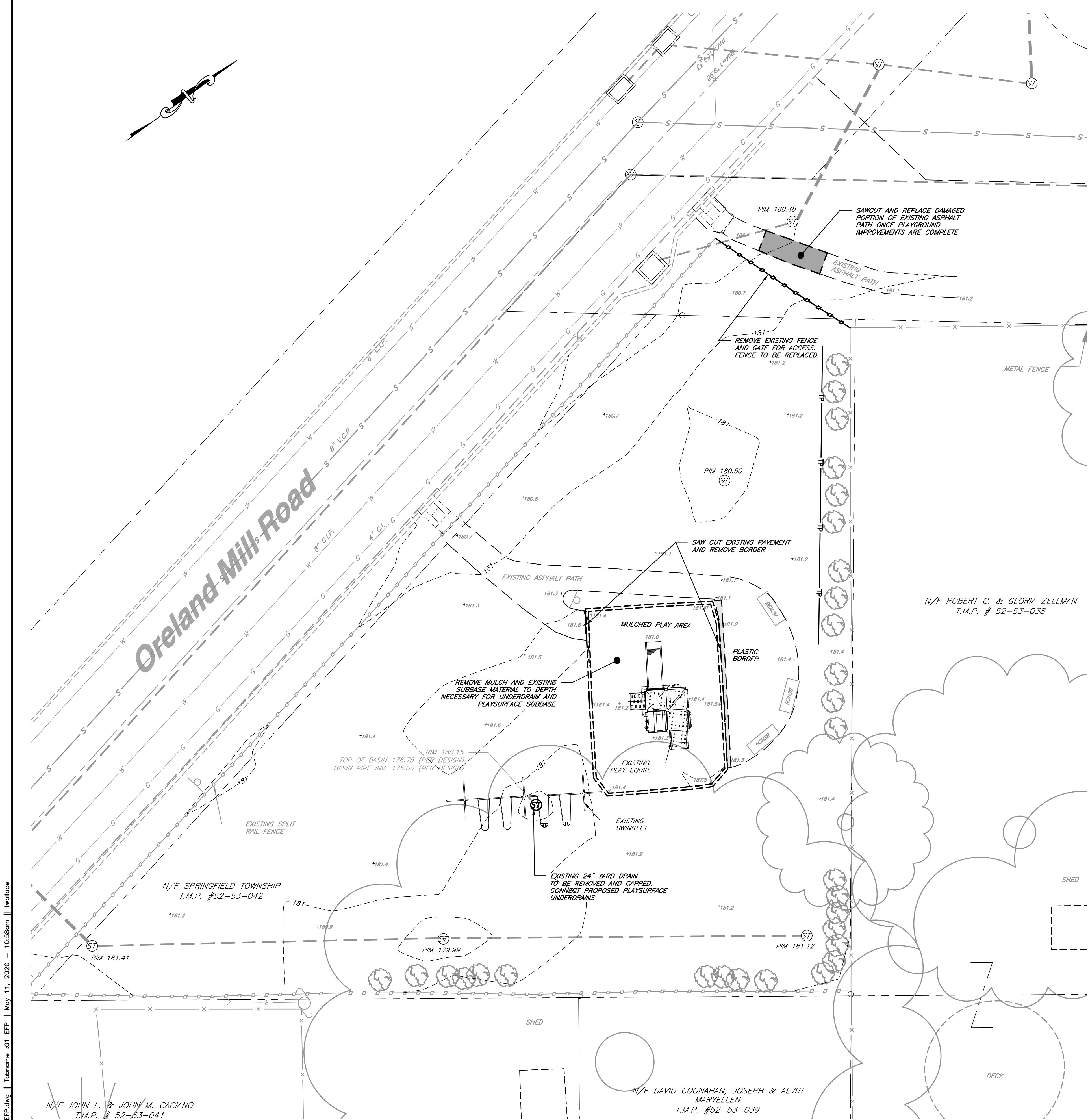

- ### GENERAL NOTES
- BOUNDARY INFORMATION SHOWN HEREON IS BASED UPON ORELAND MILL ROAD DRAINAGE IMPROVEMENTS PROJECT PLAN SET PREPARED BY BOUCHER & JAMES, INC. DATED JANUARY 26, 2010 WITH NO REVISIONS AND SUPPLEMENTAL FIELD SURVEY WAS CONDUCTED BY BOUCHER & JAMES, INC. DURING MARCH OF 2020.
  - THIS SURVEY WAS PERFORMED WITHOUT THE BENEFIT OF A TITLE REPORT.
  - THE PROPERTY SHOWN HEREON IS SUBJECT TO ANY RIGHTS-OF-WAY, EASEMENTS AND/OR COVENANTS OF RECORD THAT A TITLE REPORT MAY DISCLOSE.
  - THE BEARINGS ALONG PROPERTY LINES SHOWN HEREON ARE BASED UPON DEED MERIDIAN, PA STATE PLANE, SOUTH ZONE, COORDINATE SYSTEM UTILIZING NORTH AMERICAN DATUM OF 1983 (NAD83).
  - THE ON SITE BENCHMARK FOR THIS PROJECT IS EXISTING RAIL MONUMENT LOCATED AT THE END OF INTEGRITY AVENUE, NEAR DRIVEWAY LEADING TO T.M.P. 52-53-067 N/F JAMES M. & VICTORIA COLL.
  - LOCATIONS OF EXISTING UTILITIES SHOWN HEREON ARE BASED UPON FIELD OBSERVATIONS DURING THE TIME OF SURVEY OR DEVELOPED FROM RECORDS PROVIDED BY THE RESPECTIVE USERS RESPONDING TO PENNSYLVANIA ONE-CALL SYSTEM.
  - BOUCHER & JAMES, INC. HAS NOT PERFORMED A VERIFICATION SURVEY TO DETERMINE THE EXISTENCE OF ANY UNDERGROUND UTILITY LINES WHICH MAY NOT HAVE BEEN VISIBLE AT THE TIME OF THE SURVEY.
  - ANYONE USING THIS DRAWING FOR CONSTRUCTION IS ADVISED TO CALL 1-800-242-1776 PRIOR TO EXCAVATION IN ACCORDANCE WITH PA ACT NO. 287 OF 1974, AS AMENDED.
  - NO OTHER PERSONS OR ENTITIES OTHER THAN THOSE CERTIFIED TO ON THIS PLAN MAY RELY ON THIS SURVEY.
  - ALL DIMENSIONS SHOWN HEREON ARE IN FEET AND DECIMALS THEREOF UNLESS OTHERWISE NOTED.

- ### DISPOSAL OR RECYCLING
- INDIVIDUALS RESPONSIBLE FOR EARTH DISTURBANCE ACTIVITIES MUST ENSURE THAT PROPER MECHANISMS ARE IN PLACE TO CONTROL WASTE MATERIALS. CONSTRUCTION WASTE INCLUDE THINGS SUCH AS, BUT ARE NOT LIMITED TO, EXCESS SOIL MATERIALS, DAMAGED NETTING OR MATTING, SANITARY WASTES, GENERAL TRASH, ETC. THAT COULD ADVERSELY EFFECT OR IMPACT WATER QUALITY. MEASURES SHOULD BE PLANNED AND IMPLEMENTED FOR HOUSEKEEPING OF THE SITE, MATERIALS MANAGEMENT, AND LITTER CONTROL. WHEREVER POSSIBLE, RECYCLING OF EXCESS MATERIALS IS PREFERRED, RATHER THAN DISPOSAL.
- SEDIMENT REMOVED FROM EROSION CONTROL MEASURES OR FACILITIES AND OTHER SOILS DEEMED UNSUITABLE FOR USE AS FILL SHALL BE STABILIZED AND DISPOSED OF OFF SITE AT AN APPROVED FACILITY. OFF-SITE DISPOSAL MUST COMPLY WITH ALL LOCAL, COUNTY, STATE AND FEDERAL RULES, REGULATIONS AND LAWS.

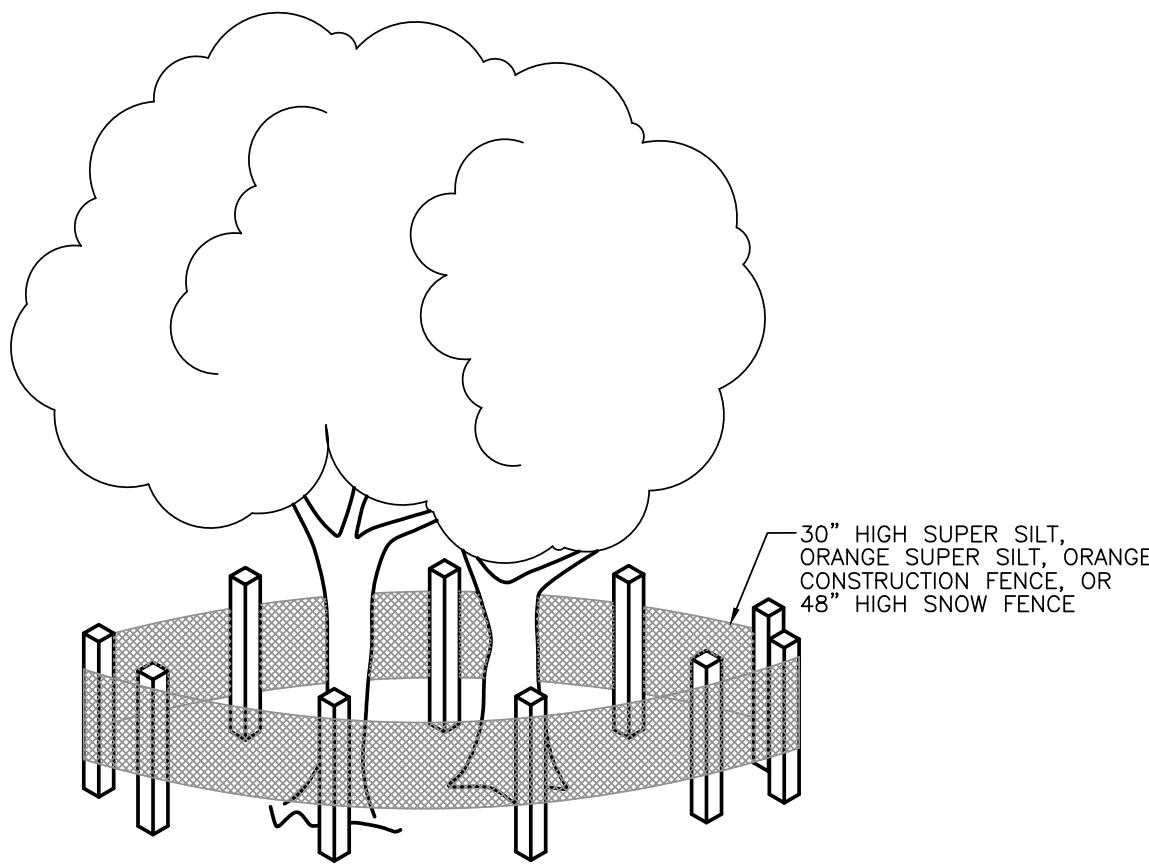

- ### NOTES :
- TREE PROTECTION FENCE TO BE LOCATED AT ALONG THE BOUNDARY OF THE TREE PROTECTION ZONE (TPZ) AS DEMARCATED IN THE PLAN SET. THE TPZ SHALL BE LOCATED A MINIMUM OF 15' FROM TRUNK OR AS SHOWN ON THE PLAN.
  - FENCE TO BE MOUNTED ON STEEL POSTS LOCATED EIGHT (8) FEET ON CENTER.
  - FENCE TO BE INSTALLED IN ACCORDANCE WITH THE PLAN SET AND INSPECTED PRIOR TO COMMENCING CLEARING AND FURTHER CONSTRUCTION.
  - TREE PROTECTION FENCING SHALL BE MAINTAINED UNTIL ALL WORK AND CONSTRUCTION HAVE BEEN COMPLETED. ANY DAMAGES TO TREE PROTECTION FENCING SHALL BE REPAIRED BEFORE CONSTRUCTION MAY CONTINUE.
  - TPZ TO BE PROTECTED IN ACCORDANCE WITH THE REQUIREMENTS OF SLDO SECTION 205-53 AND AS SPECIFIED IN THIS PLAN SET.

### TREE PROTECTION FENCING

NOT TO SCALE

### MAJOR SOIL PROPERTIES AND ESTIMATED DEGREE OF LIMITATION THAT INFLUENCE USE OF SOILS FOR CONSTRUCTION/DEVELOPMENT

MAP SYMBOL	SOIL	HYDROLOGIC GROUP	DEPTH TO		CONSTRUCTION MATERIALS				SOILS FEATURES THAT AFFECT:		
			HWT (FT)	BEDROCK (IN)	ROAD FILL	SAND	GRAVEL	TOPSOIL	ROADS AND PARKING LOTS	CONSTRUCTION AND MAINT. OF PIPELINES	PONDS - RESERVOIR AREAS
UrB	URBAN LAND-DUFFIELD COMPLEX 0 TO 8% SLOPES	B	<6.5	48 - 120	FAIR	POOR	POOR	UNSUITABLE	MODERATE; CAVERNS IN BEDROCK	DEPTH TO BEDROCK VARIABLE	PERMEABLE SUBSTRATUM; EXCESSIVE SEEPAGE

SOURCE: WEB SOIL SURVEY

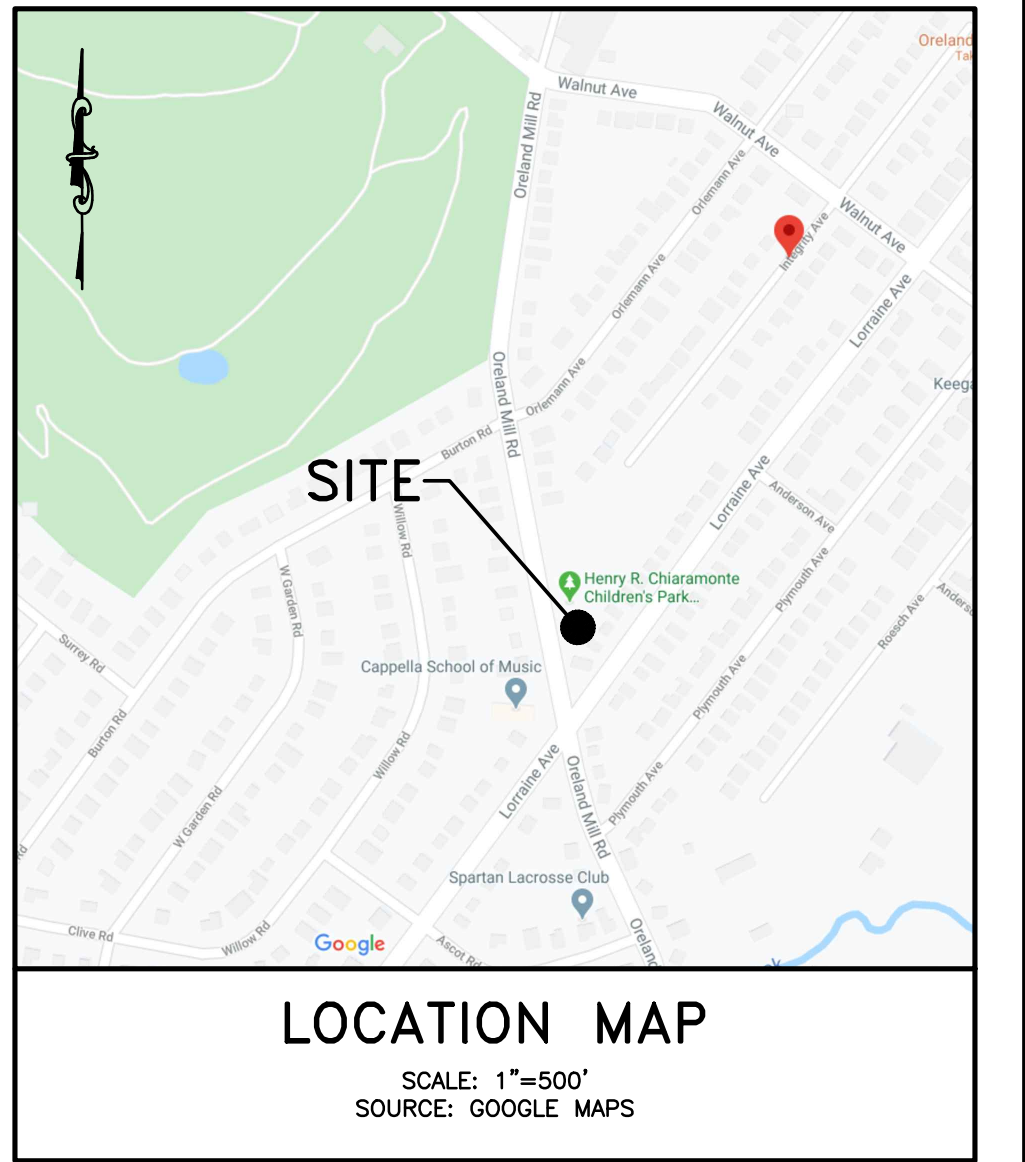

- ### LEGEND
- ADJOINER LINE
  - EXISTING BUILDINGS
  - EXISTING CENTERLINE
  - EXISTING CONTOUR
  - EXISTING INDEX CONTOUR
  - EXISTING CURBLINE
  - EXISTING ELECTRIC AND STRUCTURES
  - EXISTING EDGE OF PAVEMENT
  - EXISTING CHAINLINK FENCE
  - EXISTING SPLIT RAIL FENCE
  - EXISTING GAS LINE AND STRUCTURE
  - EXISTING LIGHTS
  - EXISTING LEGAL RIGHT-OF-WAY
  - EXISTING SANITARY SEWER AND MANHOLE
  - EXISTING SHRUB
  - EXISTING SIGN
  - EXISTING SITE BENCHMARK LOCATION
  - EXISTING SPOT ELEVATIONS
  - EXISTING STORM SEWER AND STRUCTURES
  - EXISTING UTILITY POLE AND GUY WIRE
  - EXISTING WATER LINE AND STRUCTURES
  - EXISTING DECIDUOUS TREE
  - EXISTING CONIFEROUS TREE
  - EXISTING FEATURE TO BE REMOVED
  - TREE PROTECTION FENCE



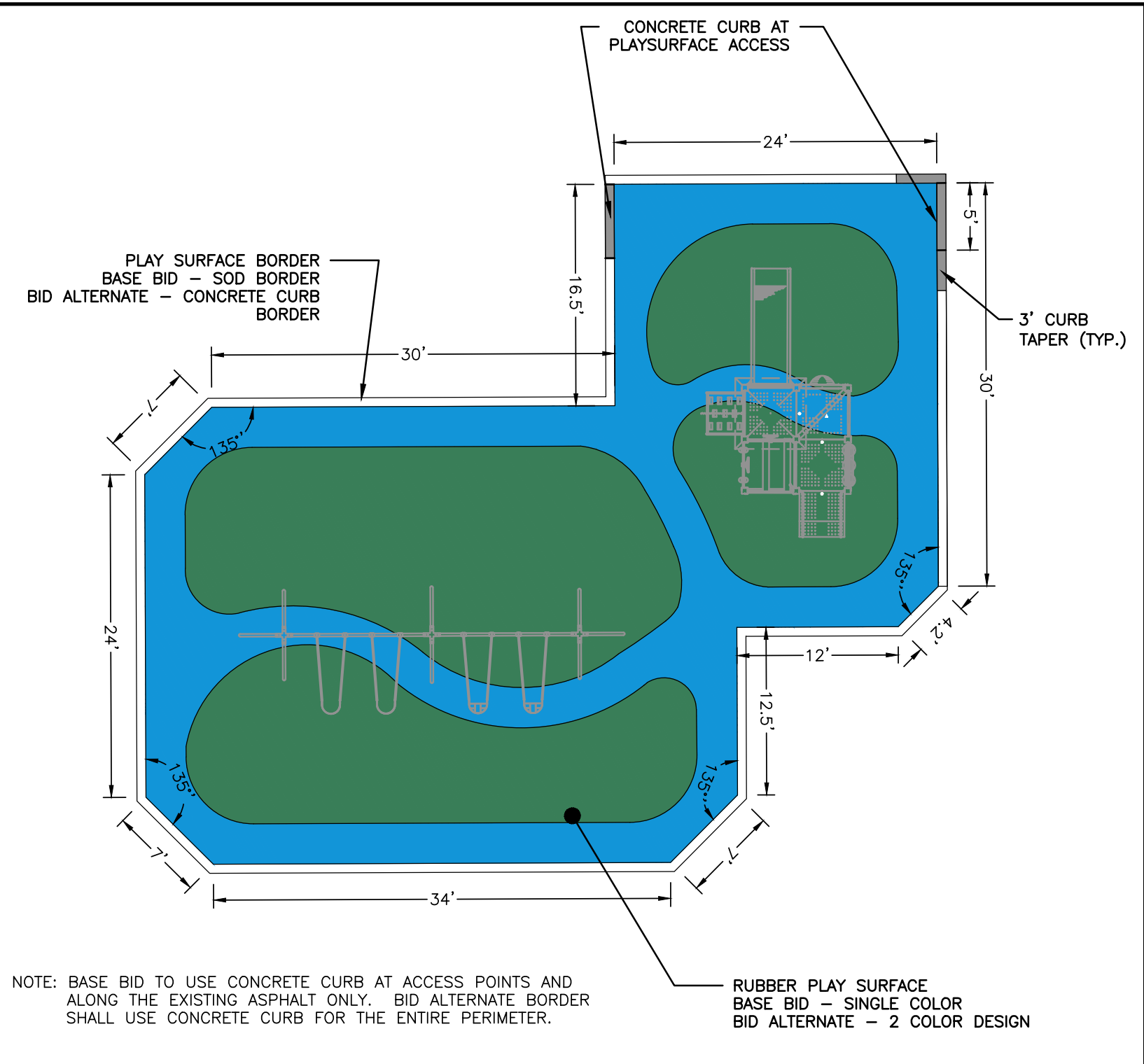
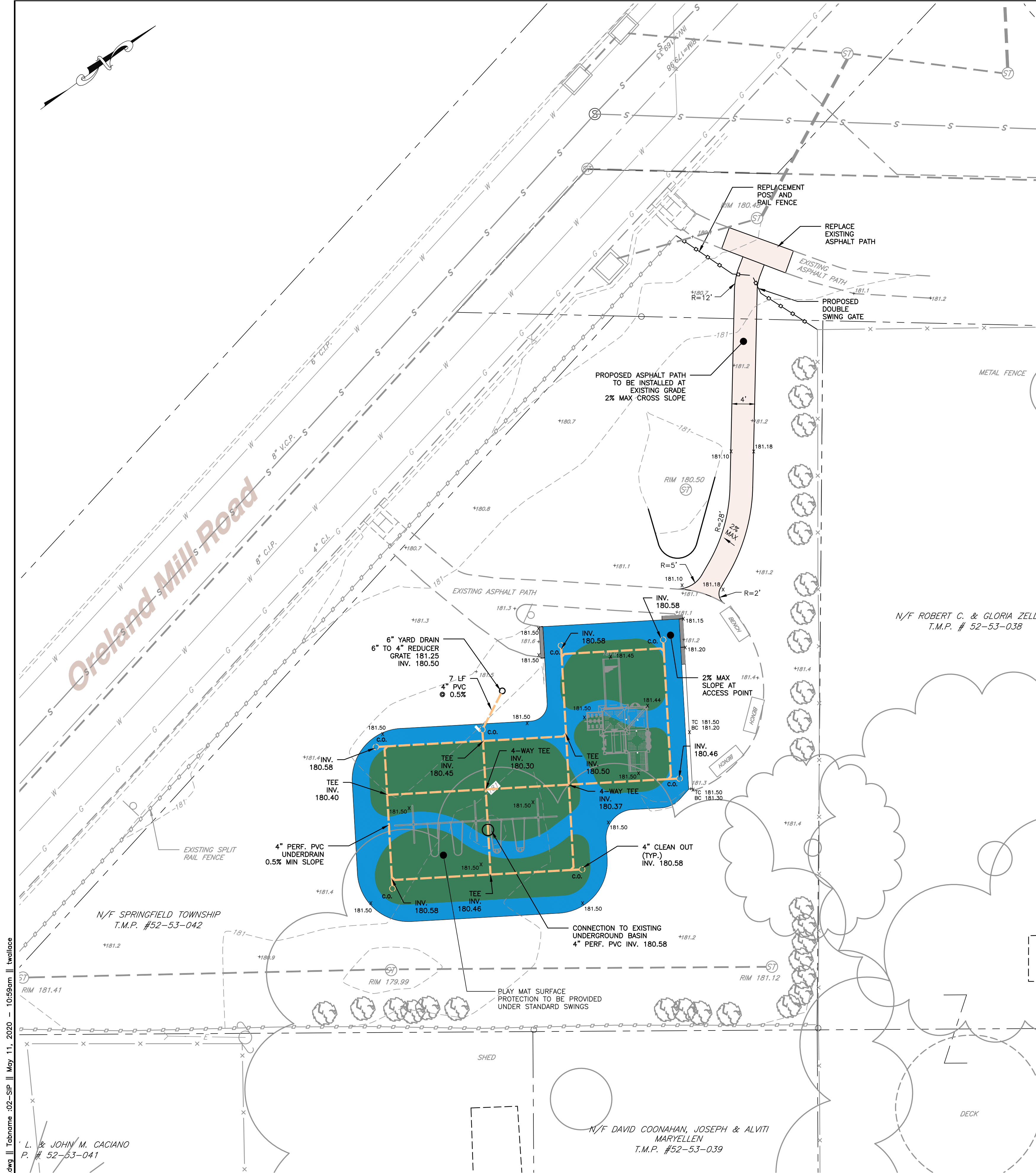

PLAYGROUND SAFETY SURFACE BORDER LAYOUT

SCALE 1" = 10'

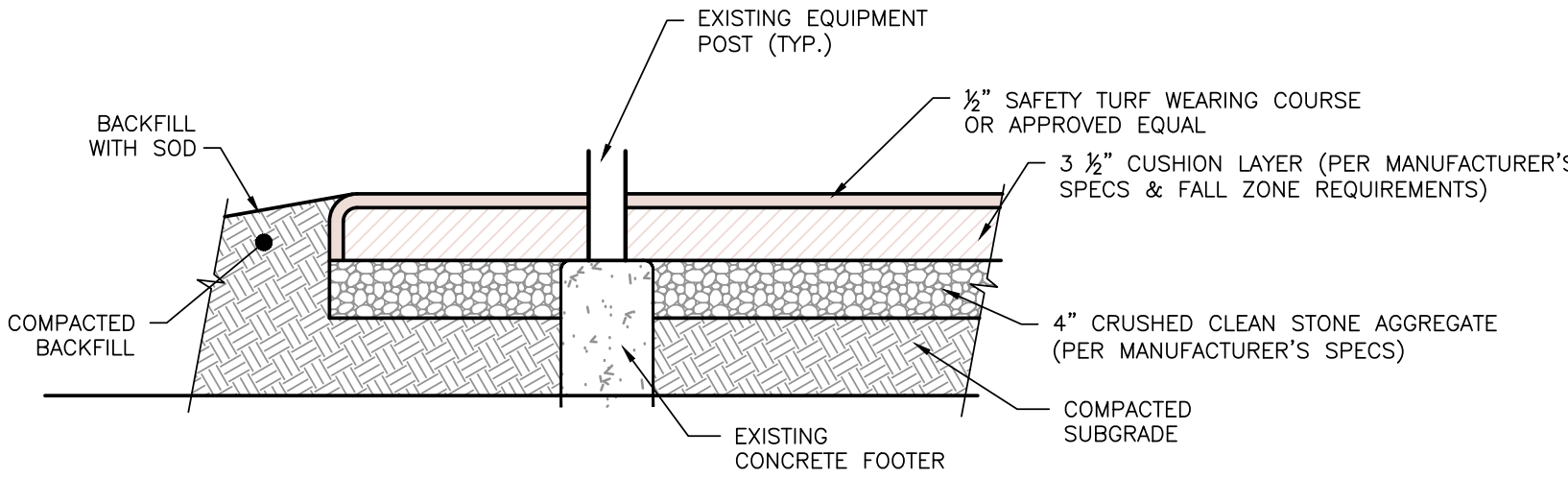

NOTE: SAFETY TURF (OR APPROVED EQUAL) TO BE INSTALLED BY APPROVED INSTALLER PER MANUFACTURER'S SPECIFICATIONS.

PLAYGROUND SAFETY SURFACE CROSS SECTION - BASE BID

NOT TO SCALE

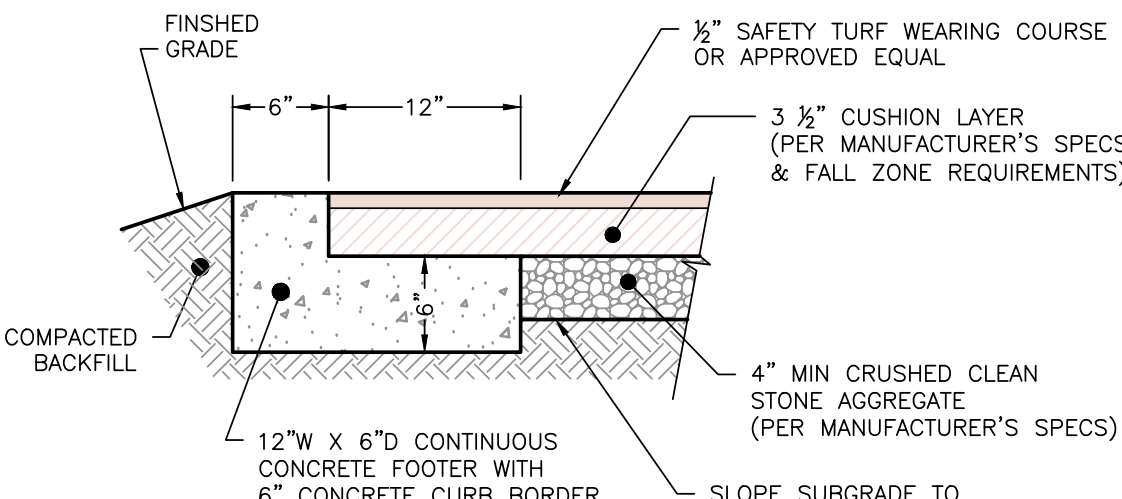

SAFETY SURFACE CURB BORDER

NOT TO SCALE

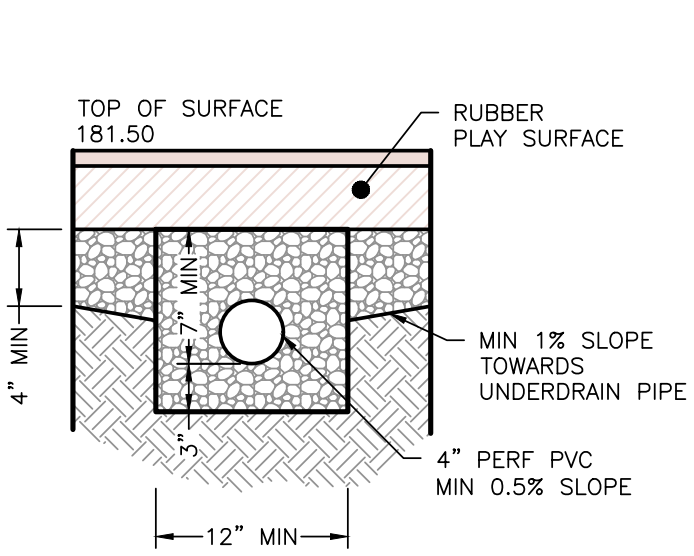

UNDERDRAIN DETAIL

NOT TO SCALE

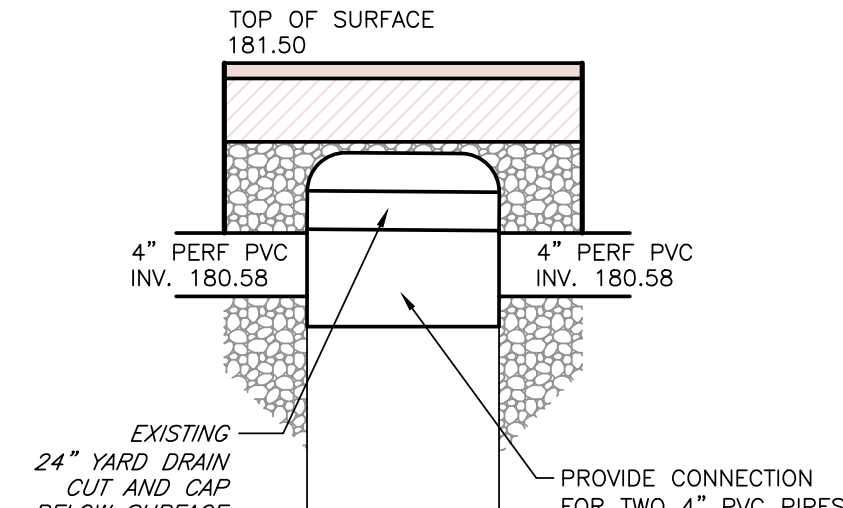

UNDERDRAIN CONNECTION

NOT TO SCALE

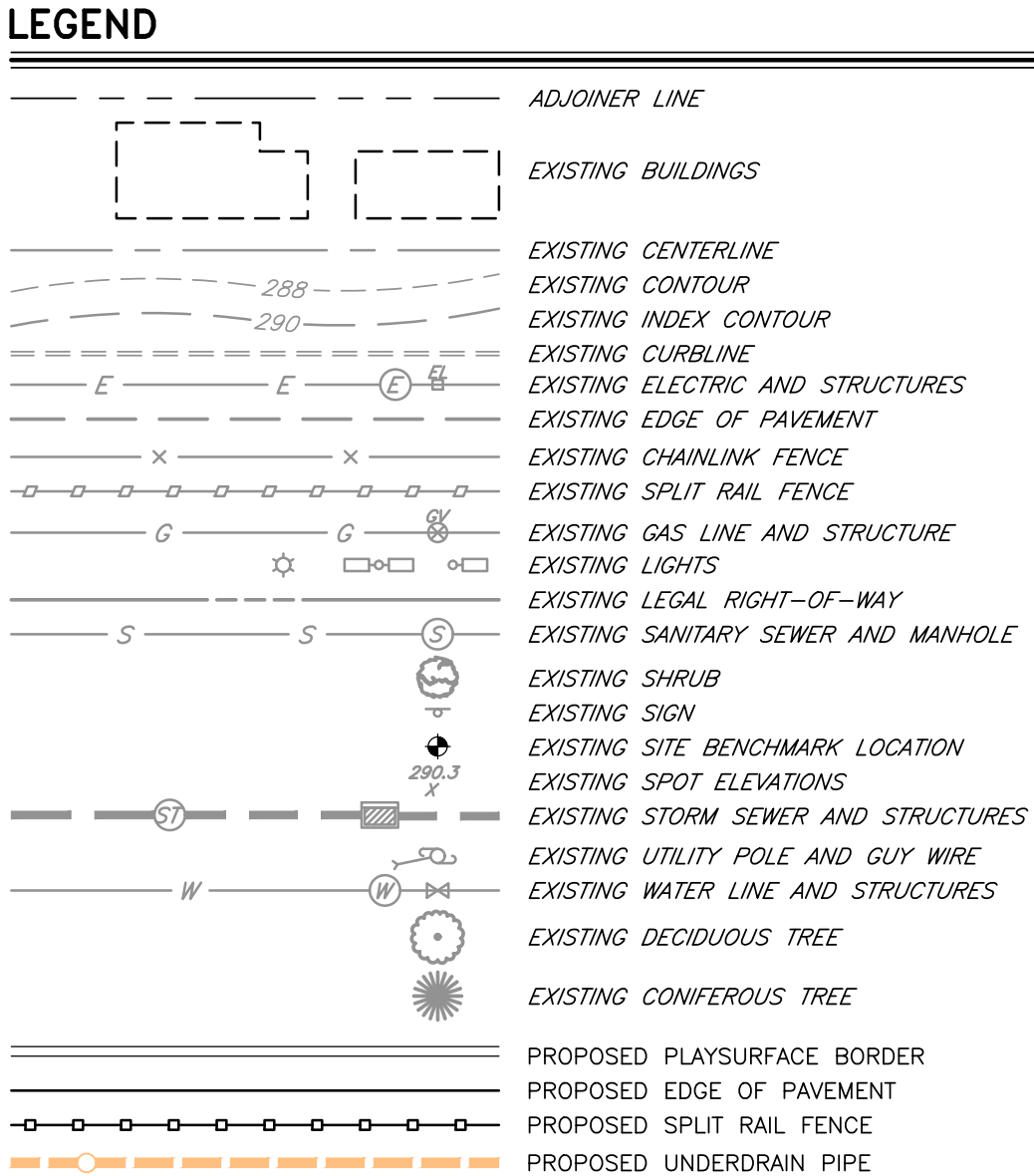

GRADING AND DRAINAGE NOTES:

ALL CONSTRUCTION SHALL BE IN ACCORDANCE WITH THE REQUIREMENTS OF SPRINGFIELD TOWNSHIP, AND PENNDOT PUBLICATION 408, LATEST EDITION.

THE PROPOSED FINISHED GRADING SHOWN ON THIS PLAN HAS BEEN USED TO DESIGN THE STORM WATER MANAGEMENT FACILITIES.

THE CONTRACTOR SHALL COMPLY WITH THE GENERAL GRADING SCHEME INDICATED UNLESS OTHERWISE APPROVED BY THE TOWNSHIP ENGINEER.

CONTRACTOR SHALL NOT ENCRoACH ONTO ADJOINING PROPERTIES UNLESS A TEMPORARY CONSTRUCTION EASEMENT HAS BEEN GRANTED BY THE ADJOINING PROPERTY OWNER.

ALL CONTRACTORS WORKING ON THIS PROJECT SHALL BE RESPONSIBLE FOR INSURING THAT ALL CONSTRUCTION ACTIVITIES RELATED TO THIS PROJECT ARE PERFORMED IN ACCORDANCE WITH ALL APPLICABLE OSHA (OCCUPATIONAL SAFETY AND HEALTH ADMINISTRATION) STANDARDS.

SUPERPAVE ASPHALT MIXTURE DESIGN, HMA, WEARING COURSE, PG 64-22, 0.0 TO 3.0 MILLION ESALS, 9.5 MM MIX, 2" DEPTH, SRL L

CLEAN & TACK COAT IF BINDER HAS BEEN IN PLACE MORE THAN 30 DAYS.

SUBGRADE - COMPACTED TO 95% MODIFIED PROCTOR DENSITY VALUE.

BITUMINOUS PAVEMENT WALKWAY - SECTION

NOT TO SCALE

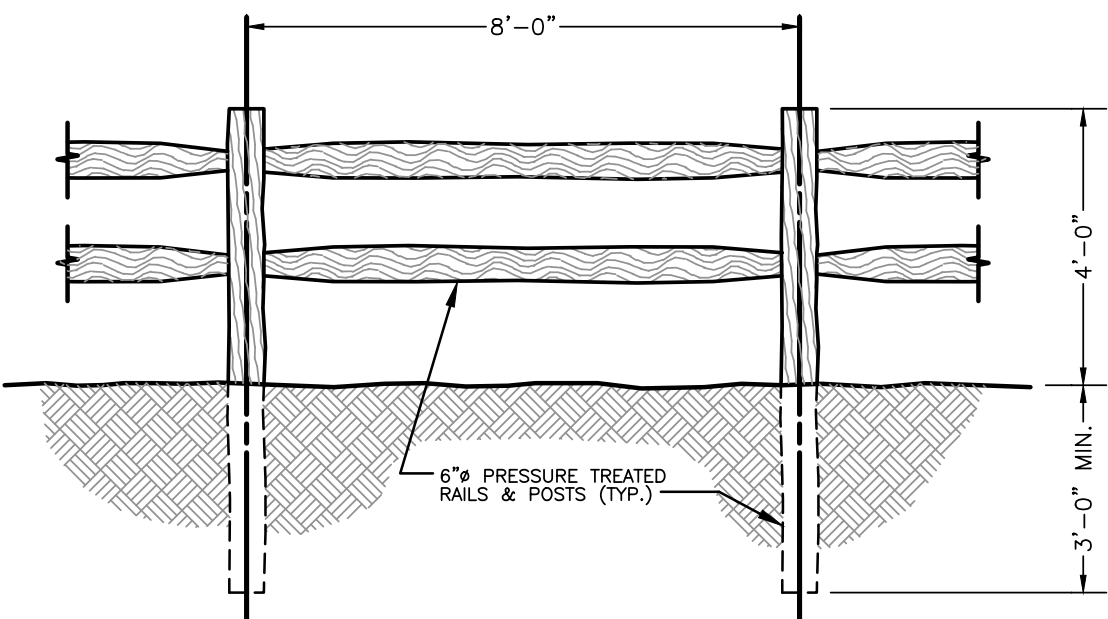

NOTE: SHOP DRAWINGS TO BE SUBMITTED FOR REVIEW AND APPROVAL OF DOUBLE SWING SPLIT RAIL FENCE GATE (3' WIDE EACH) AND LOCKING HARDWARE.

SPLIT RAIL FENCE DETAIL

NOT TO SCALE

Written dimensions shall have priority over scaled dimensions. All dimensions, elevations, locations, and conditions, shall be verified by the Contractor prior to construction, and the Owner and Boucher & James, Inc. shall be notified of any discrepancies with the information shown on drawings. Only those plans incorporating the raised or red ink professional seal shall be considered official and relied upon. All ideas, designs and arrangements presented herein were developed for use on, and in connection with, the specified project being prepared for the Owner. These plans may not be reproduced or altered without the expressed written permission of Boucher & James, Inc. Information shown on this plan represents professional services expressing ideas and designs developed, owned and copyrighted by Boucher & James, Inc. Reproduction of this plan without written approval of Boucher & James, Inc. is not permitted. Unauthorized reproduction of a copy of this plan for any purpose will be considered a violation of the copyright laws and a theft of corporate assets. Unauthorized alterations of the plan will be considered a violation of the professional code of ethics. Any violation will be prosecuted to the fullest extent of current statutes.

REVISIONS :		DATE		DESCRIPTION	

PROJECT : CHIARAMONTE PARK ADA IMPROVEMENTS  
SPRINGFIELD TOWNSHIP  
MONTGOMERY COUNTY, PENNSYLVANIA  
APPLICANT : SPRINGFIELD TOWNSHIP  
1510 PAPER MILL ROAD  
WYNDMORR, PA 19038

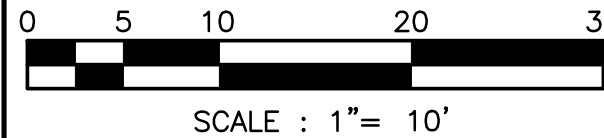

JOB NO.: 1940161  
DRAWN BY: TMW  
CHECKED BY: MWE  
SCALE: 1" = 10'  
PLAN STATUS: FINAL

PROJECT NAME : CHIARAMONTE PARK ADA IMPROVEMENTS

SITE IMPROVEMENT PLAN

**Boucher & James, Inc.**  
CONSULTING ENGINEERS  
DOYLESTOWN • BETHLEHEM • STROUDSBURG  
CORPORATE HEADQUARTERS: 1456 FERRY RD, BUILDING 500, DOYLESTOWN, PA. 18901  
VOICE: (215) 345-9400 FAX: (215) 345-9401

**SHEET**  
2 OF 3  
DATE: MAY 8, 2020



CONSTRUCTION SEQUENCE

1. INSTALL ROCK CONSTRUCTION ENTRANCE.
2. INSTALL COMPOST FILTER SOCKS, TREE PROTECTION FENCE AND INLET PROTECTION AS INDICATED ON THE EROSION & SEDIMENTATION CONTROL PLAN.
3. REMOVE/ RELOCATE EXISTING FEATURES AS NECESSARY FOR CONSTRUCTION AS INDICATED ON EXISTING FEATURES AND DEMOLITION PLAN.
4. STRIP TOPSOIL FROM SITE, STOCKPILE TOPSOIL ON THE DESIGNATED AREA AS INDICATED ON PLAN. INSTALL THE STOCKPILE PERIMETER COMPOST FILTER SOCK AND IMMEDIATELY APPLY TEMPORARY SEEDING AND MULCHING. STOCKPILE HEIGHTS MUST NOT EXCEED 35 FEET. STOCKPILE SLOPES MUST BE 2:1 OR FLATTER.
5. EXCAVATE FOR UNDERDRAIN PIPE, PLAY SURFACE BORDER AND ASPHALT PATH. HAUL EXCESS MATERIAL OFFSITE.
6. INSTALL PROPOSED UNDERDRAIN PIPE, SAFETY SURFACING AND BORDER.
7. INSTALL ASPHALT PATH OTHER PROPOSED IMPROVEMENTS.
8. FINISH GRADE, SEED AND MULCH REMAINING GREEN AREA ONSITE.
9. REMOVE EXCESS TOPSOIL FROM SITE.
10. AFTER FINAL SITE STABILIZATION HAS BEEN ACHIEVED, ALL OF THE REMAINING TEMPORARY EROSION AND SEDIMENT CONTROLS MUST BE REMOVED AND THE SITE MUST BE PERMANENTLY STABILIZED. THE STANDARD FOR A STABILIZED, EROSION RESISTANT, PERENNIAL VEGETATIVE COVER WILL BE A UNIFORM COVERAGE OR DENSITY OF 70% ACROSS THE DISTURBED AREA. AREAS DISTURBED DURING THE REMOVAL OF THE TEMPORARY CONTROLS MUST BE STABILIZED IMMEDIATELY.
11. PERMANENTLY SEED ANY REMAINING DISTURBED AREAS.

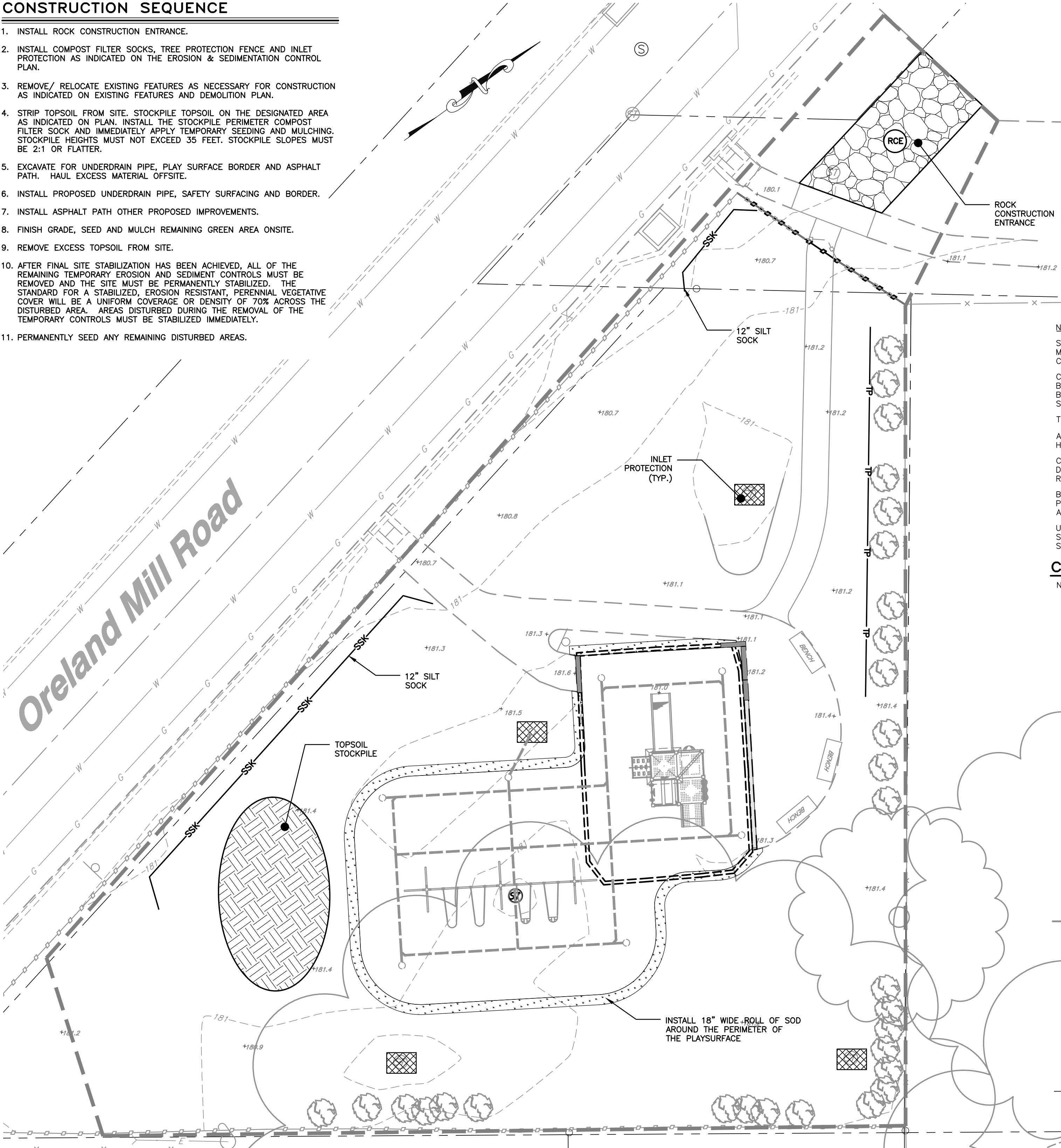

PERMANENT SEED MIX

DISTURBED AREAS TO BE PERMANENTLY SEEDED SHALL BE SEEDED WITH ERNST COMMERCIAL CONSERVATION MIX ERNMX-113 AT A RATE OF 75-150 LBS./AC. OR APPROVED EQUIVALENT.		
BOTANICAL NAME	COMMON NAME	
25% FESTUCA RUBRA	CREeping RED FESCUE	
25% LOLIUM MULTIFLORUM	ANNUAL RYEGRASS	
25% LOLIUM PERENNE 'AMAZING GS'	PERENNIAL RYEGRASS	
25% LOLIUM PERENNE 'HOMERUN'	PERENNIAL RYEGRASS	

MIX INSTALLATION SPECIFICATIONS:

- COVER CROP INCORPORATION: A COVER CROP IS NOT REQUIRED
- SEED INSTALLATION DATES: INSTALL SEED BETWEEN APRIL 1 THROUGH JUNE 15 --OR-- SEPTEMBER 15 THROUGH NOVEMBER 1.
- ALLOW TO GROW TO 4-6" HEIGHT BEFORE MOWING.

TOPSOIL STOCKPILE AREA DETAIL

NOT TO SCALE

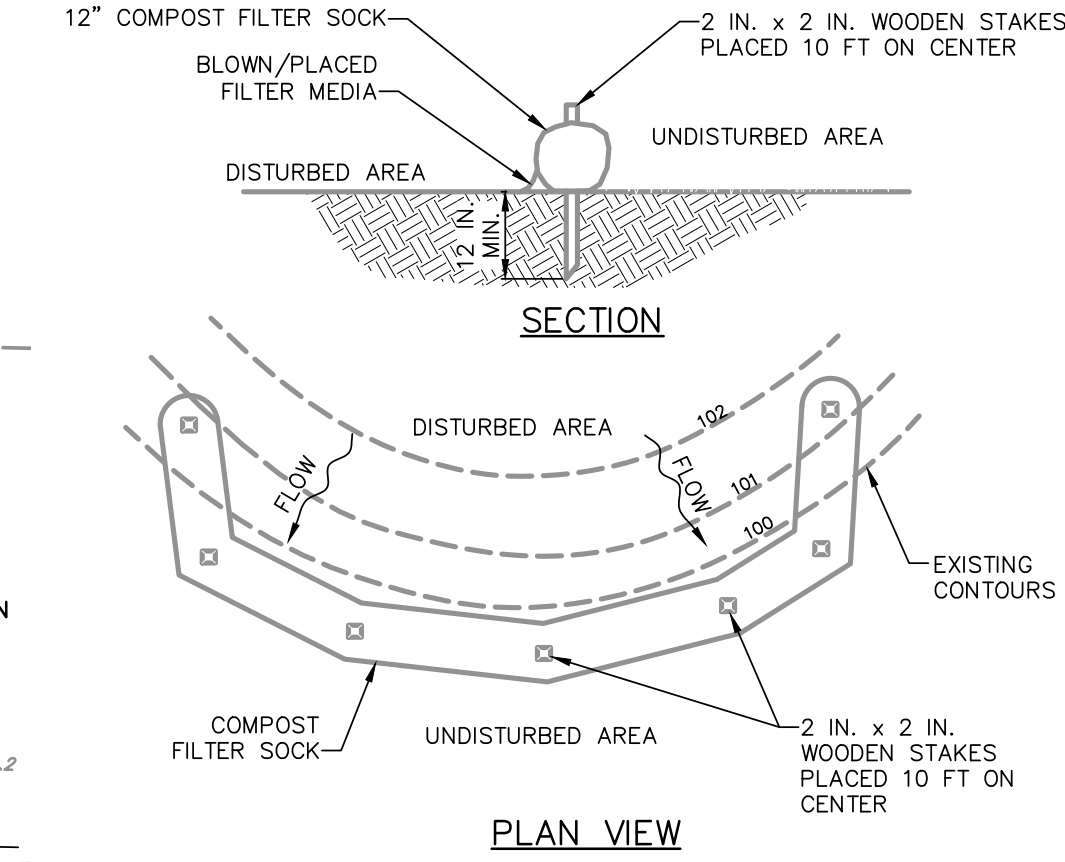
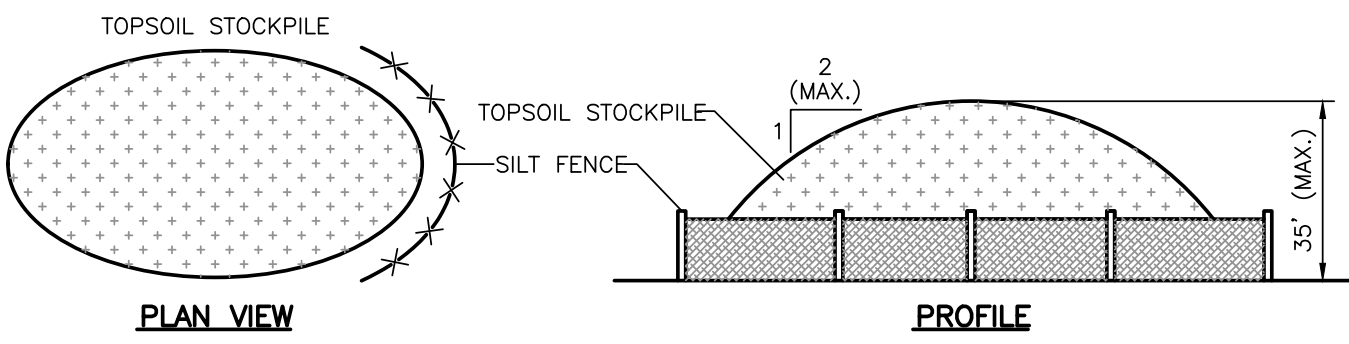

NOTES:

SOCK FABRIC SHALL MEET STANDARDS OF TABLE 4.1 OF THE PA DEP EROSION CONTROL MANUAL. COMPOST SHALL MEET THE STANDARDS OF TABLE 4.2 OF THE PA DEP EROSION CONTROL MANUAL.

COMPOST FILTER SOCK SHALL BE PLACED AT EXISTING LEVEL GRADE. BOTH ENDS OF THE BARRIER SHALL BE EXTENDED AT LEAST 8 FEET UP SLOPE AT 45 DEGREES TO THE MAIN BARRIER ALIGNMENT. MAXIMUM SLOPE LENGTH ABOVE ANY BARRIER SHALL NOT EXCEED THAT SPECIFIED FOR THE SIZE OF THE SOCK AND THE SLOPE OF ITS TRIBUTARY AREA.

TRAFFIC SHALL NOT BE PERMITTED TO CROSS COMPOST FILTER SOCKS.

ACCUMULATED SEDIMENT SHALL BE REMOVED WHEN IT REACHES 1/2 THE ABOVE GROUND HEIGHT OF THE BARRIER AND DISPOSED IN THE MANNER DESCRIBED ELSEWHERE IN THE PLAN.

COMPOST FILTER SOCKS SHALL BE INSPECTED WEEKLY AND AFTER EACH RUNOFF EVENT. DAMAGED SOCKS SHALL BE REPAIRED ACCORDING TO MANUFACTURER'S SPECIFICATIONS OR REPLACED WITHIN 24 HOURS OF INSPECTION.

BIODEGRADABLE COMPOST FILTER SOCKS SHALL BE REPLACED AFTER 6 MONTHS; PHOTODEGRADABLE SOCKS AFTER 1 YEAR. POLYPROPYLENE SOCKS SHALL BE REPLACED ACCORDING TO MANUFACTURER'S RECOMMENDATIONS.

UPON STABILIZATION OF THE AREA TRIBUTARY TO THE SOCK, STAKES SHALL BE REMOVED. THE SOCK MAY BE LEFT IN PLACE AND VEGETATED OR REMOVED. IN THE LATTER CASE, THE MESH SHALL BE CUT OPEN AND THE MULCH SPREAD AS A SOIL SUPPLEMENT.

COMPOST FILTER SOCK

NOT TO SCALE

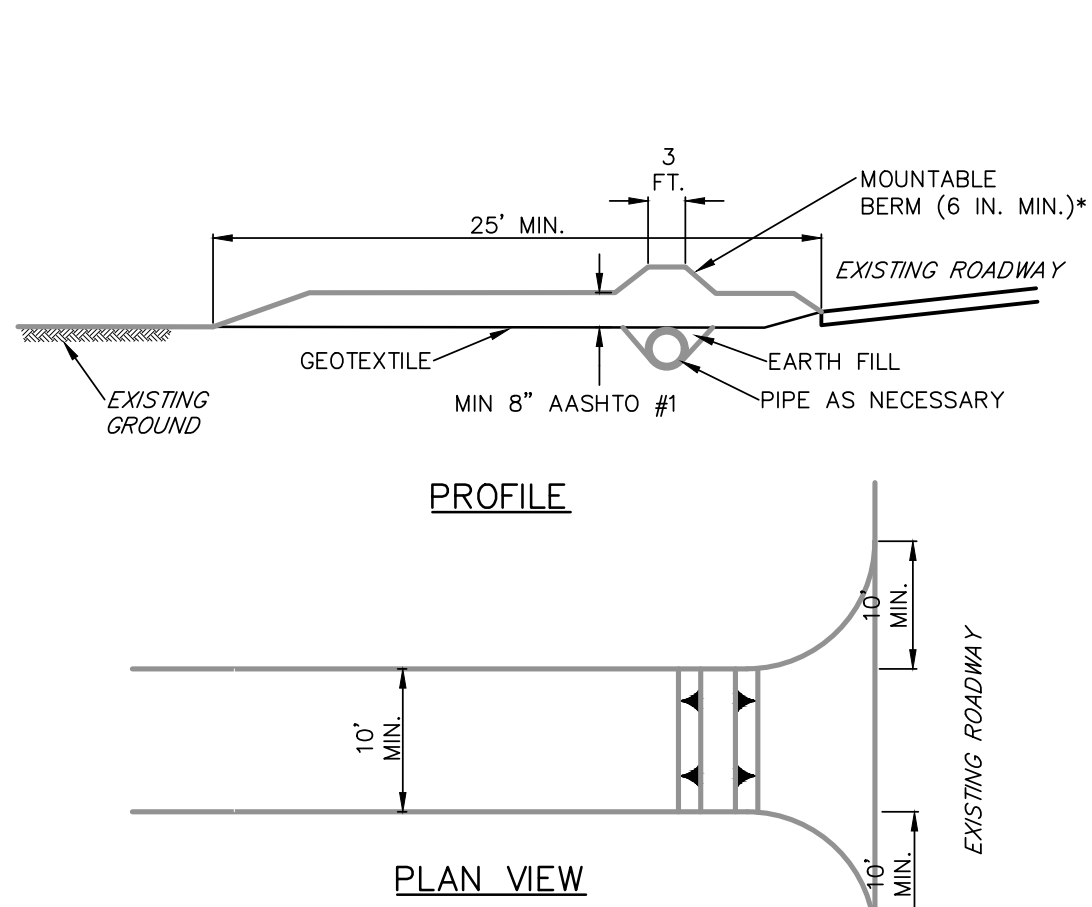

NOTES:

REMOVE TOPSOIL PRIOR TO INSTALLATION OF ROCK CONSTRUCTION ENTRANCE. EXTEND ROCK OVER FULL WIDTH OF ENTRANCE.

RUNOFF SHALL BE DIVERTED FROM ROADWAY TO A SUITABLE SEDIMENT REMOVAL BMP PRIOR TO ENTERING ROCK CONSTRUCTION ENTRANCE.

MOUNTABLE BERM SHALL BE INSTALLED WHEREVER OPTIONAL CULVERT PIPE IS USED AND PROPER PIPE COVER AS SPECIFIED BY MANUFACTURER IS NOT OTHERWISE PROVIDED. PIPE SHALL BE SIZED APPROPRIATELY FOR SIZE OF DITCH BEING CROSSED.

MAINTENANCE: ROCK CONSTRUCTION ENTRANCE THICKNESS SHALL BE CONSTANTLY MAINTAINED TO THE SPECIFIED DIMENSIONS BY ADDING ROCK. A STOCKPILE SHALL BE MAINTAINED ON SITE FOR THIS PURPOSE. ALL SEDIMENT DEPOSITED ON PAVED ROADWAYS SHALL BE REMOVED AND RETURNED TO THE CONSTRUCTION SITE IMMEDIATELY. IF EXCESSIVE AMOUNTS OF SEDIMENT ARE BEING DEPOSITED ON ROADWAY, EXCEEDING LENGTH OF ROCK CONSTRUCTION ENTRANCE BY 50 FOOT INCREMENTS UNTIL CONDITION IS ALLEVIATED OR INSTALL WASH RACK. WASHING THE ROADWAY OR SWEEPING THE DEPOSITS INTO ROADWAY DITCHES, SEWERS, CULVERTS, OR OTHER DRAINAGE COURSES IS NOT ACCEPTABLE.

ROCK CONSTRUCTION ENTRANCE

NOT TO SCALE

LEGEND

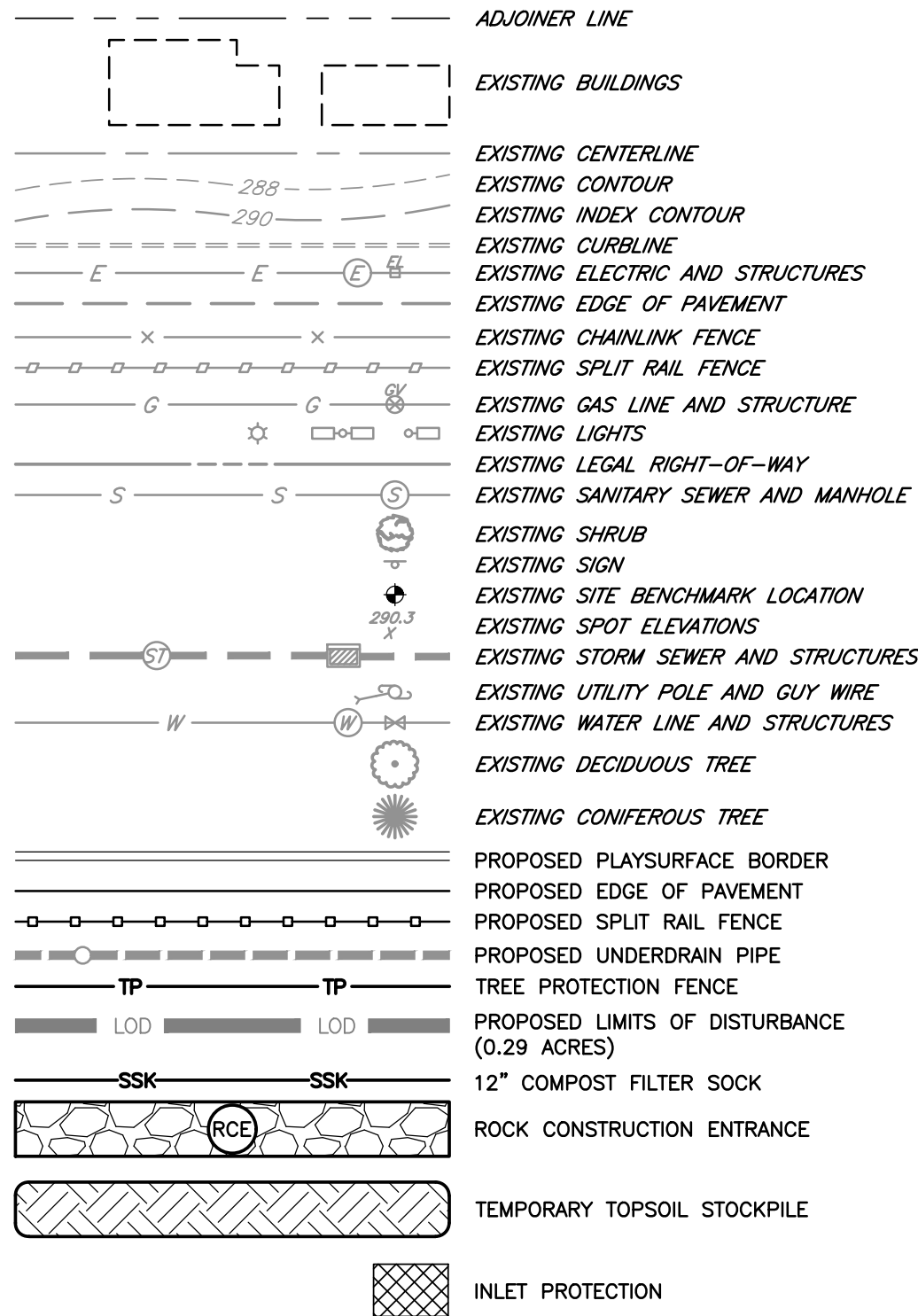

EROSION & SEDIMENTATION CONTROL NOTES

1. ALL EARTH DISTURBANCES, INCLUDING CLEARING AND GRUBBING AS WELL AS CUTS AND FILLS SHALL BE DONE IN ACCORDANCE WITH THE APPROVED E&S PLAN. A COPY OF THE APPROVED DRAWINGS (STAMPED, SIGNED AND DATED BY THE REVIEWING AGENCY) MUST BE AVAILABLE AT THE PROJECT SITE AT ALL TIMES. THE REVIEWING AGENCY SHALL BE NOTIFIED OF ANY CHANGES TO THE APPROVED PLAN PRIOR TO IMPLEMENTATION OF THOSE CHANGES. THE REVIEWING AGENCY MAY REQUIRE A WRITTEN SUBMITTAL OF THOSE CHANGES FOR REVIEW AND APPROVAL AT ITS DISCRETION.
2. AT LEAST 7 DAYS PRIOR TO STARTING ANY EARTH DISTURBANCE ACTIVITIES, INCLUDING CLEARING AND GRUBBING, THE OWNER AND/OR OPERATOR SHALL INVITE ALL CONTRACTORS, THE LANDOWNER, APPROPRIATE MUNICIPAL OFFICIALS, THE E&S PLAN PREPARER, THE PCSM PLAN PREPARER, THE LICENSED PROFESSIONAL RESPONSIBLE FOR OVERSIGHT OF CRITICAL STAGES OF IMPLEMENTATION OF THE PCSM PLAN, AND A REPRESENTATIVE FROM THE LOCAL CONSERVATION DISTRICT TO AN ON-SITE PRECONSTRUCTION MEETING.
3. AT LEAST 3 DAYS PRIOR TO STARTING ANY EARTH DISTURBANCE ACTIVITIES, OR EXPANDING INTO AN AREA PREVIOUSLY UNMARKED, THE PENNSYLVANIA ONE CALL SYSTEM INC. SHALL BE NOTIFIED AT 1-800-242-1776 FOR THE LOCATION OF EXISTING UNDERGROUND UTILITIES.
4. ALL EARTH DISTURBANCE ACTIVITIES SHALL BE DONE IN ACCORDANCE WITH THE SEQUENCE PROVIDED ON THE PLAN DRAWINGS. DEVIATION FROM THAT SEQUENCE MUST BE APPROVED IN WRITING FROM THE LOCAL CONSERVATION DISTRICT OR BY THE DEPARTMENT PRIOR TO IMPLEMENTATION.
5. AREAS TO BE FILLED ARE TO BE CLEARED, GRUBBED, AND STRIPPED OF TOPSOIL TO REMOVE TREES, VEGETATION, ROOTS AND OTHER OBJECTIONABLE MATERIAL.
6. CLEARING, GRUBBING, AND TOPSOIL STRIPPING SHALL BE LIMITED TO THOSE AREAS DESCRIBED IN EACH STAGE OF THE CONSTRUCTION SEQUENCE. GENERAL SITE CLEARING OR GRUBBING AND TOPSOIL STRIPPING MAY NOT COMMENCE IN ANY STAGE OR PHASE OF THE PROJECT UNTIL THE E&S BMPs SPECIFIED BY THE BMP SEQUENCE FOR THAT STAGE OR PHASE HAVE BEEN INSTALLED AND ARE FUNCTIONING AS DESCRIBED IN THIS E&S PLAN.
7. AT NO TIME SHALL CONSTRUCTION VEHICLES BE ALLOWED TO ENTER AREAS OUTSIDE THE LIMIT OF DISTURBANCE BOUNDARIES SHOWN ON THE PLAN MAPS. THESE AREAS MUST BE CLEARLY MARKED AND FENCED OFF BEFORE CLEARING AND GRUBBING OPERATIONS BEGIN.
8. TOPSOIL REQUIRED FOR THE ESTABLISHMENT OF VEGETATION SHALL BE STOCKPILED AT THE LOCATION(S) SHOWN ON THE PLAN MAP(S) IN THE AMOUNT NECESSARY TO COMPLETE THE FINISH GRADING OF ALL EXPOSED AREAS THAT ARE TO BE STABILIZED BY VEGETATION. EACH STOCKPILE SHALL BE PROTECTED IN THE MANNER SHOWN ON THE PLAN DRAWINGS. STOCKPILE HEIGHTS SHALL NOT EXCEED 35 FEET. STOCKPILE SLOPES SHALL BE 2H:1V OR FLATTER.
9. IMMEDIATELY UPON DISCOVERING UNFORESEEN CIRCUMSTANCES POSING THE POTENTIAL FOR ACCELERATED EROSION AND/OR SEDIMENT POLLUTION, THE OPERATOR SHALL IMPLEMENT APPROPRIATE BEST MANAGEMENT PRACTICES TO MINIMIZE THE POTENTIAL FOR EROSION AND SEDIMENT POLLUTION AND NOTIFY THE LOCAL CONSERVATION DISTRICT AND/OR THE REGIONAL OFFICE OF THE DEPARTMENT.
10. ALL BUILDING MATERIALS AND WASTES SHALL BE REMOVED FROM THE SITE AND RECYCLED OR DISPOSED OF IN ACCORDANCE WITH THE DEPARTMENT'S SOLID WASTE MANAGEMENT REGULATIONS AT 25 PA. CODE 2801.1, ET SEQ. NO BUILDING MATERIALS OR WASTES OR UNUSED BUILDING MATERIALS SHALL BE BURNED, BURIED, DUMPED, OR DISCHARGED AT THE SITE.
11. ALL OFF-SITE WASTE AND BORROW AREAS MUST HAVE AN E&S PLAN APPROVED BY THE LOCAL CONSERVATION DISTRICT OR THE DEPARTMENT FULLY IMPLEMENTED PRIOR TO BEING ACTIVATED.
12. THE CONTRACTOR IS RESPONSIBLE FOR ENSURING THAT ANY MATERIAL BROUGHT ON SITE IS CLEAN FILL. FORM FP-001 MUST BE RETAINED BY THE PROPERTY OWNER FOR ANY FILL MATERIAL AFFECTED BY A SPILL OR RELEASE OF A REGULATED SUBSTANCE BUT QUALIFYING AS CLEAN FILL DUE TO ANALYTICAL TESTING.
13. ALL PUMPING OF WATER FROM ANY WORK AREA SHALL BE DONE ACCORDING TO THE PROCEDURE DESCRIBED IN THIS PLAN, OVER UNDISTURBED VEGETATED AREAS.
14. UNTIL THE SITE IS STABILIZED, ALL EROSION AND SEDIMENT BMPs SHALL BE MAINTAINED PROPERLY. MAINTENANCE SHALL INCLUDE INSPECTIONS OF ALL EROSION AND SEDIMENT BMPs AFTER EACH RUNOFF EVENT AND ON A WEEKLY BASIS. ALL PREVENTATIVE AND REMEDIAL MAINTENANCE WORK, INCLUDING CLEAN OUT, REPAIR, REPLACEMENT, REGRADING, RESEEDING, REMULCHING AND RENETTING MUST BE PERFORMED IMMEDIATELY. IF THE E&S BMPs FAIL TO PERFORM AS EXPECTED, REPLACEMENT BMPs, OR MODIFICATIONS OF THOSE INSTALLED WILL BE REQUIRED.
15. A LOG SHOWING DATES THAT E&S BMPs WERE INSPECTED AS WELL AS ANY DEFICIENCIES FOUND AND THE DATE THEY WERE CORRECTED SHALL BE MAINTAINED ON THE SITE AND BE MADE AVAILABLE TO REGULATORY AGENCY OFFICIALS AT THE TIME OF INSPECTION.
16. SEDIMENT TRACKED ONTO ANY PUBLIC ROADWAY OR SIDEWALK SHALL BE RETURNED TO THE CONSTRUCTION SITE BY THE END OF EACH WORK DAY AND DISPOSED IN THE MANNER DESCRIBED IN THIS PLAN. IN NO CASE SHALL THE SEDIMENT BE WASHED, SHOVELED, OR SWEEPED INTO ANY ROADSIDE DITCH, STORM SEWER, OR SURFACE WATER.
17. ALL SEDIMENT REMOVED FROM BMPs SHALL BE DISPOSED OF IN THE MANNER DESCRIBED ON THE PLAN DRAWINGS.
18. AREAS WHICH ARE TO BE TOPSOILED SHALL BE SCARPED TO A MINIMUM DEPTH OF 3 TO 5 INCHES. 6 TO 12 INCHES ON COMPACTED SOILS --- PRIOR TO PLACEMENT OF TOPSOIL, AREAS TO BE VEGETATED SHALL HAVE A MINIMUM 4 INCHES OF TOPSOIL IN PLACE PRIOR TO SEEDING AND MULCHING. FILL OUTSLOPES SHALL HAVE A MINIMUM OF 2 INCHES OF TOPSOIL.
19. ALL FILLS SHALL BE COMPACTED AS REQUIRED TO REDUCE EROSION, SLIPPAGE, SETTLEMENT, SUBSIDENCE OR OTHER RELATED PROBLEMS. FILL INTENDED TO SUPPORT BUILDINGS, STRUCTURES AND CONDUITS, ETC. SHALL BE COMPACTED IN ACCORDANCE WITH LOCAL REQUIREMENTS OR CODES.
20. ALL EARTHEN FILLS SHALL BE PLACED IN COMPACTED LAYERS NOT TO EXCEED 9 INCHES IN THICKNESS.
21. FILL MATERIALS SHALL BE FREE OF FROZEN PARTICLES, BRUSH, ROOTS, SOD, OR OTHER FOREIGN OR OBJECTIONABLE MATERIALS THAT WOULD INTERFERE WITH OR PREVENT CONSTRUCTION OF SATISFACTORY FILL.
22. FROZEN MATERIALS OR SOFT, MUCKY, OR HIGHLY COMPRESSIBLE MATERIALS SHALL NOT BE INCORPORATED INTO FILLS.
23. FILL SHALL NOT BE PLACED ON SATURATED OR FROZEN SURFACES.
24. SEEPS OR SPRINGS ENCOUNTERED DURING CONSTRUCTION SHALL BE HANDLED IN ACCORDANCE WITH THE STANDARD AND SPECIFICATION FOR SUBSURFACE DRAIN OR OTHER APPROVED METHOD.
25. ALL GRADED AREAS SHALL BE PERMANENTLY STABILIZED IMMEDIATELY UPON REACHING FINISHED GRADE. CUT SLOPES IN COMPETENT BEDROCK AND ROCK FILLS NEED NOT BE VEGETATED. SEEDING AREAS WITHIN 50 FEET OF A SURFACE WATER, OR AS OTHERWISE SHOWN ON THE PLAN DRAWINGS, SHALL BE BLANKETED ACCORDING TO THE STANDARDS OF THIS PLAN.
26. IMMEDIATELY AFTER EARTH DISTURBANCE ACTIVITIES CEASE IN ANY AREA OR SUBAREA OF THE PROJECT, THE OPERATOR SHALL STABILIZE ALL DISTURBED AREAS. DURING NON-GERMINATING MONTHS, MULCH OR PROTECTIVE BLANKETING SHALL BE APPLIED AS DESCRIBED IN THE PLAN. AREAS NOT AT FINISHED GRADE, WHICH WILL BE REACTIVATED WITHIN 1 YEAR, MAY BE STABILIZED IN ACCORDANCE WITH THE TEMPORARY STABILIZATION SPECIFICATIONS. THOSE AREAS WHICH WILL NOT BE REACTIVATED WITHIN 1 YEAR SHALL BE STABILIZED IN ACCORDANCE WITH THE PERMANENT STABILIZATION SPECIFICATIONS.
27. PERMANENT STABILIZATION IS DEFINED AS A MINIMUM UNIFORM, PERENNIAL 70% VEGETATIVE COVER OR OTHER PERMANENT NON-VEGETATIVE COVER WITH A DENSITY SUFFICIENT TO RESIST ACCELERATED EROSION. CUT AND FILL SLOPES SHALL BE CAPABLE OF RESISTING FAILURE DUE TO SLUMPING, SLIDING, OR OTHER MOVEMENTS.
28. E&S BMPs SHALL REMAIN FUNCTIONAL AS SUCH UNTIL ALL AREAS TRIBUTARY TO THEM ARE PERMANENTLY STABILIZED OR UNTIL THEY ARE REPLACED BY ANOTHER BMP APPROVED BY THE LOCAL CONSERVATION DISTRICT OR THE DEPARTMENT.
29. UPON COMPLETION OF ALL EARTH DISTURBANCE ACTIVITIES AND PERMANENT STABILIZATION OF ALL DISTURBED AREAS, THE OWNER AND/OR OPERATOR SHALL CONTACT THE LOCAL CONSERVATION DISTRICT FOR AN INSPECTION PRIOR TO REMOVAL/CONVERSION OF THE E&S BMPs.
30. AFTER FINAL SITE STABILIZATION HAS BEEN ACHIEVED, TEMPORARY EROSION AND SEDIMENT BMPs MUST BE REMOVED OR CONVERTED TO PERMANENT POST CONSTRUCTION STORMWATER MANAGEMENT BMPs. AREAS DISTURBED DURING REMOVAL OR CONVERSION OF THE BMPs SHALL BE STABILIZED IMMEDIATELY. IN ORDER TO ENSURE RAPID REVEGETATION OF DISTURBED AREAS, SUCH REMOVAL/CONVERSIONS ARE TO BE DONE ONLY DURING THE GERMINATING SEASON.
31. UPON COMPLETION OF ALL EARTH DISTURBANCE ACTIVITIES AND PERMANENT STABILIZATION OF ALL DISTURBED AREAS, THE OWNER AND/OR OPERATOR SHALL CONTACT THE LOCAL CONSERVATION DISTRICT TO SCHEDULE A FINAL INSPECTION.
32. FAILURE TO CORRECTLY INSTALL E&S BMPs, FAILURE TO PREVENT SEDIMENT-LADEN RUNOFF FROM LEAVING THE CONSTRUCTION SITE, OR FAILURE TO TAKE IMMEDIATE CORRECTIVE ACTION TO RESOLVE FAILURE OF E&S BMPs MAY RESULT IN ADMINISTRATIVE, CIVIL, AND/OR CRIMINAL PENALTIES BEING INSTITUTED BY THE DEPARTMENT AS DEFINED IN SECTION 602 OF THE PENNSYLVANIA CLEAN STREAMS LAW. THE CLEAN STREAMS LAW PROVIDES FOR UP TO \$10,000 PER DAY IN CIVIL PENALTIES, UP TO \$10,000 IN SUMMARY CRIMINAL PENALTIES, AND UP TO \$25,000 IN MISDEMEANOR CRIMINAL PENALTIES FOR EACH VIOLATION.

Written dimensions shall have priority over scaled dimensions. All dimensions, elevations, locations, and conditions, shall be verified by the Contractor prior to construction, and the Owner and Boucher & James, Inc. shall be notified of any discrepancies with the information shown on drawings.

Only those plans incorporating the raised or red ink professional seal shall be considered official and relied upon. All ideas, designs and arrangements presented herein were developed for use on, and in connection with, the specified project being prepared for the Owner. These plans may not be reproduced or altered without the expressed written permission of Boucher & James, Inc.

Information shown on this plan represents professional services expressing ideas and designs developed, owned and copyrighted by Boucher & James, Inc. Reproduction of this plan without written approval of Boucher & James, Inc. is not permitted. Unauthorized reproduction of a copy of this plan for any purpose will be considered a violation of the copyright laws and a theft of corporate assets. Unauthorized alterations of the plan will be considered a violation of the professional code of ethics. Any violation will be prosecuted to the fullest extent of current statutes.

REVISIONS :			
DATE	DESCRIPTION	DATE	DESCRIPTION

PROJECT :  
**CHIARAMONTE PARK ADA IMPROVEMENTS**  
SPRINGFIELD TOWNSHIP  
MONTGOMERY COUNTY, PENNSYLVANIA

APPLICANT :  
**SPRINGFIELD TOWNSHIP**  
1510 PAPER MILL ROAD  
WYNDMORR, PA 19038

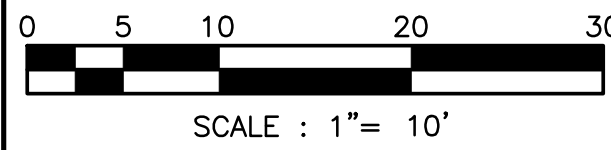

JOB NO.: <b>1940161</b>	TITLE : <b>EROSION &amp; SEDIMENTATION CONTROL PLAN</b>	
DRAWN BY: TMW		SHEET <b>3 OF 3</b>
CHECKED BY: MWE		
SCALE: 1" = 10'		
PLAN STATUS: FINAL	PROJECT NAME: <b>CHIARAMONTE PARK ADA IMPROVEMENTS</b>	DATE: MAY 8, 2020

DOYLESTOWN BETHLEHEM STROUDSBURG  
CORPORATE HEADQUARTERS: 1456 FERRY RD, BUILDING 500, DOYLESTOWN, PA. 18901  
VOICE: (215) 345-9400 FAX: (215) 345-9401  
www.bjengineers.com